

Table

Design Ceronni + Bonanomi

Every

Istruzioni di montaggio
Assembly instruction
Montageanleitung
Instructions de montage
Instrucciones de montaje

DESALTO

Installation

Step 1

- | | | | |
|----|---------------------------------------|----|---------------------------------|
| IT | Rimuovere il film trasparente | FR | Enlever le film transparent |
| EN | Remove the transparent film | ES | Quitar la película transparente |
| DE | Nehmen sie den transparenten film weg | | |

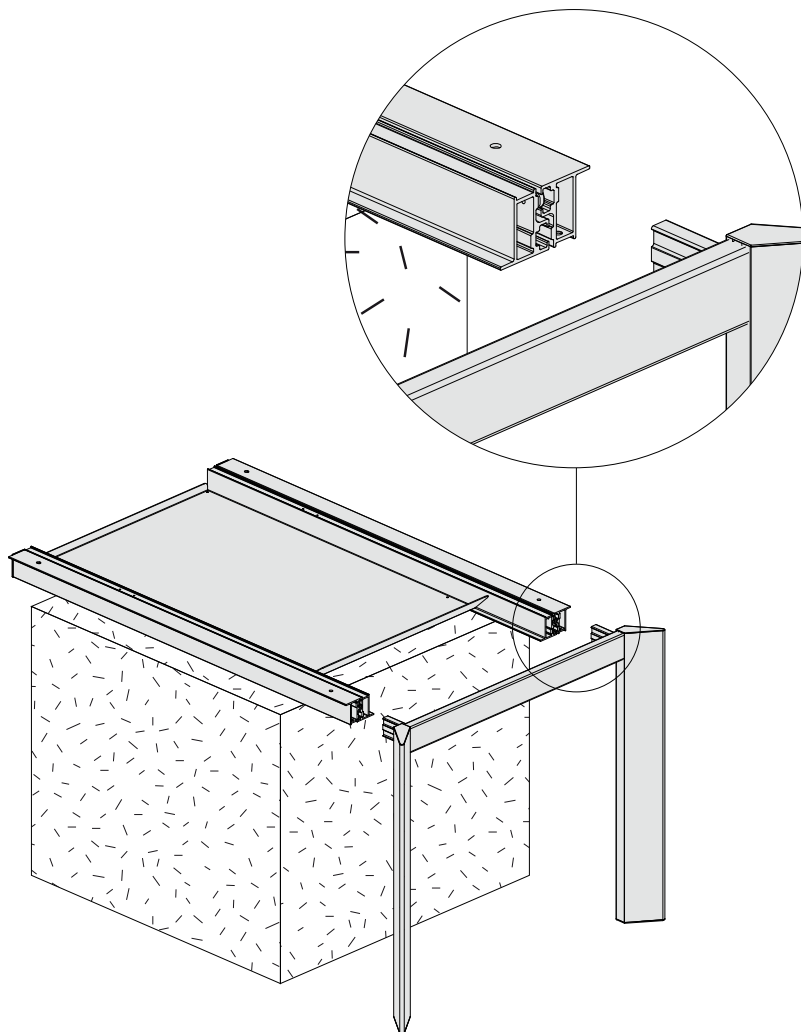

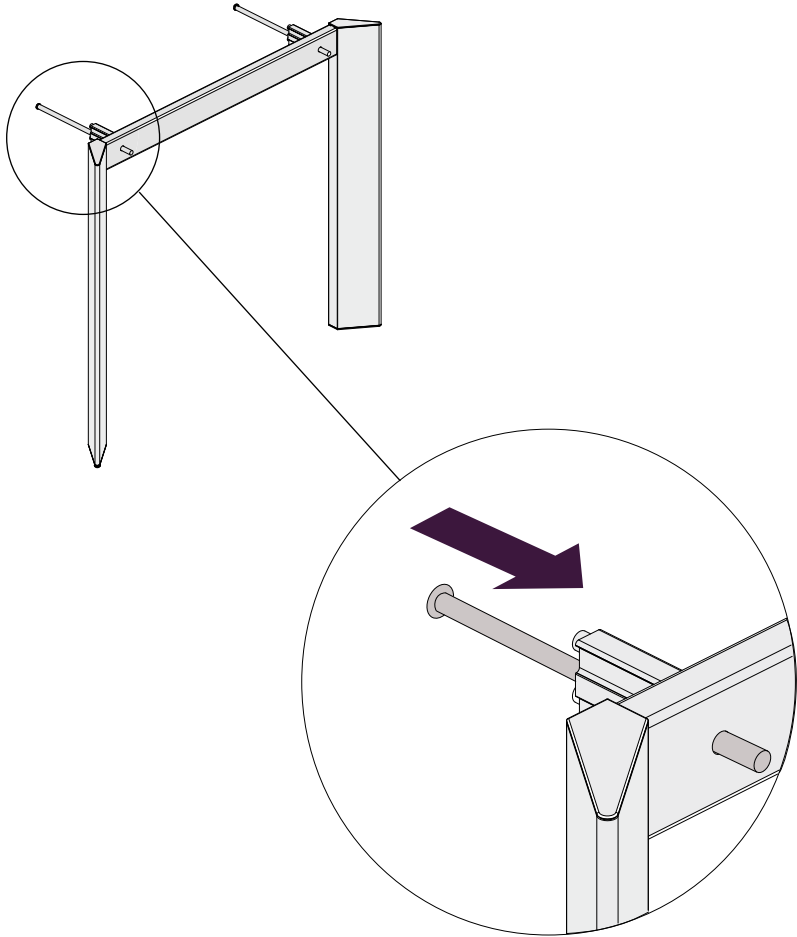

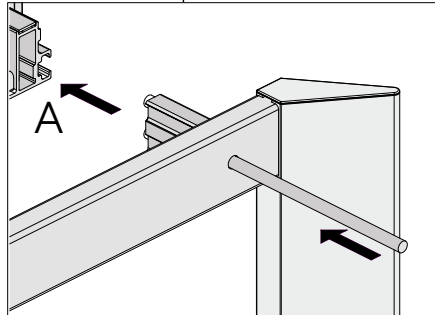
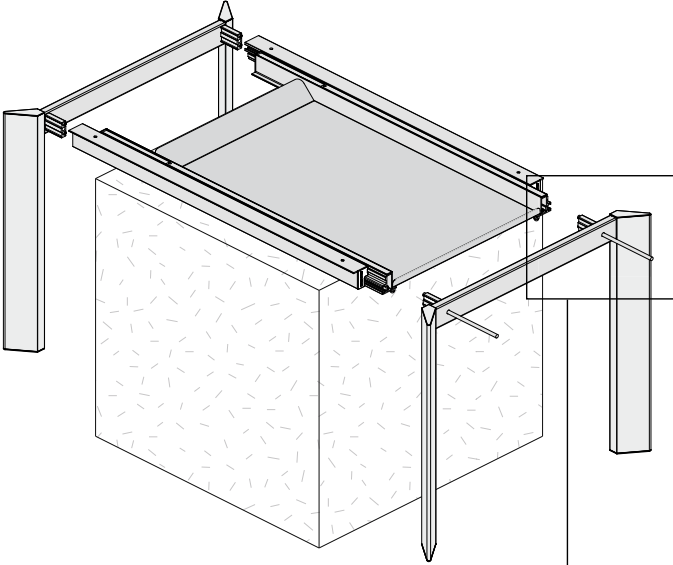

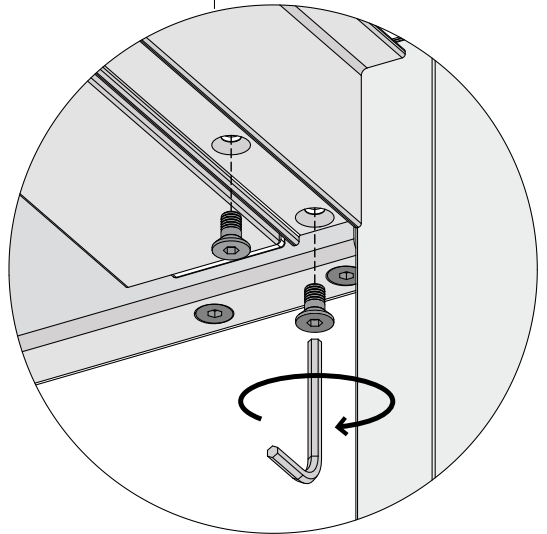
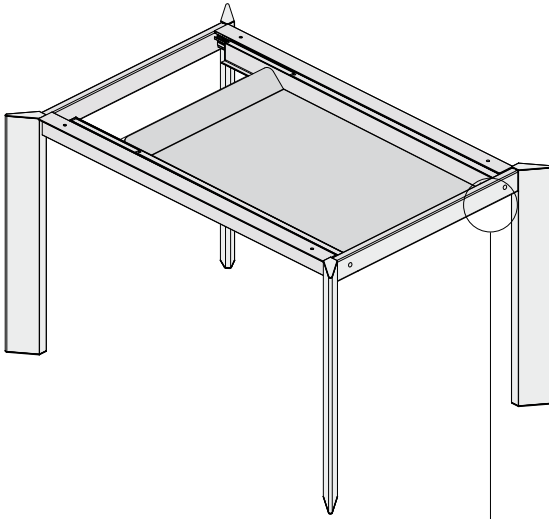

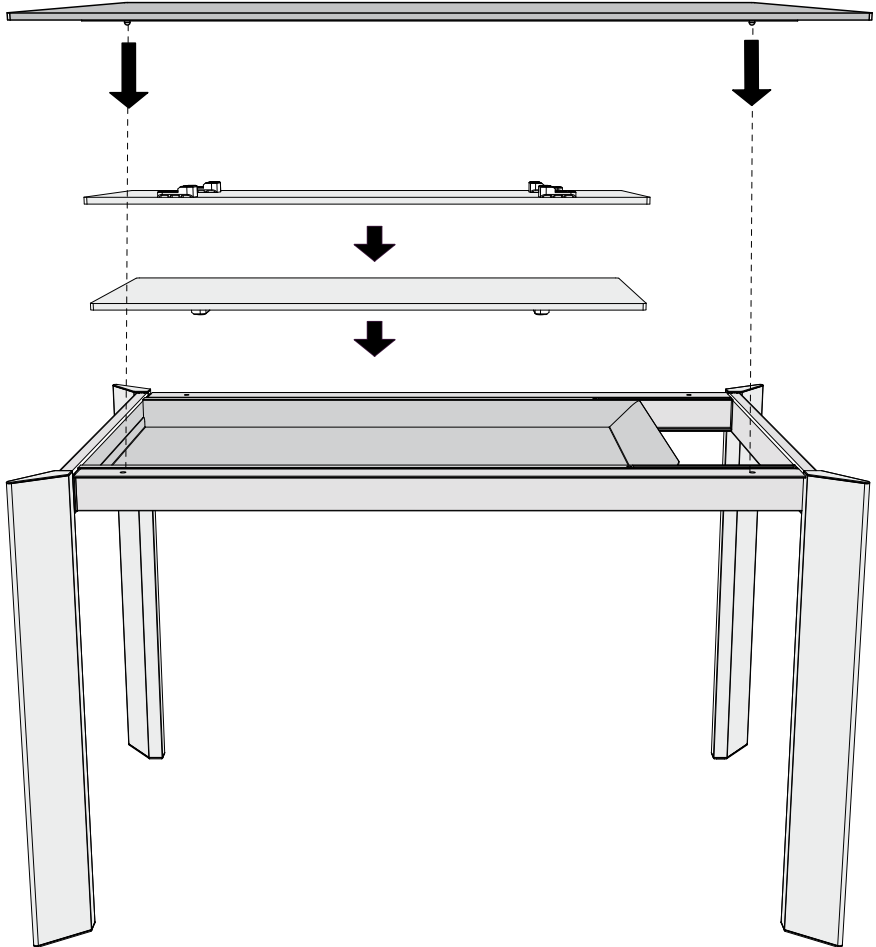

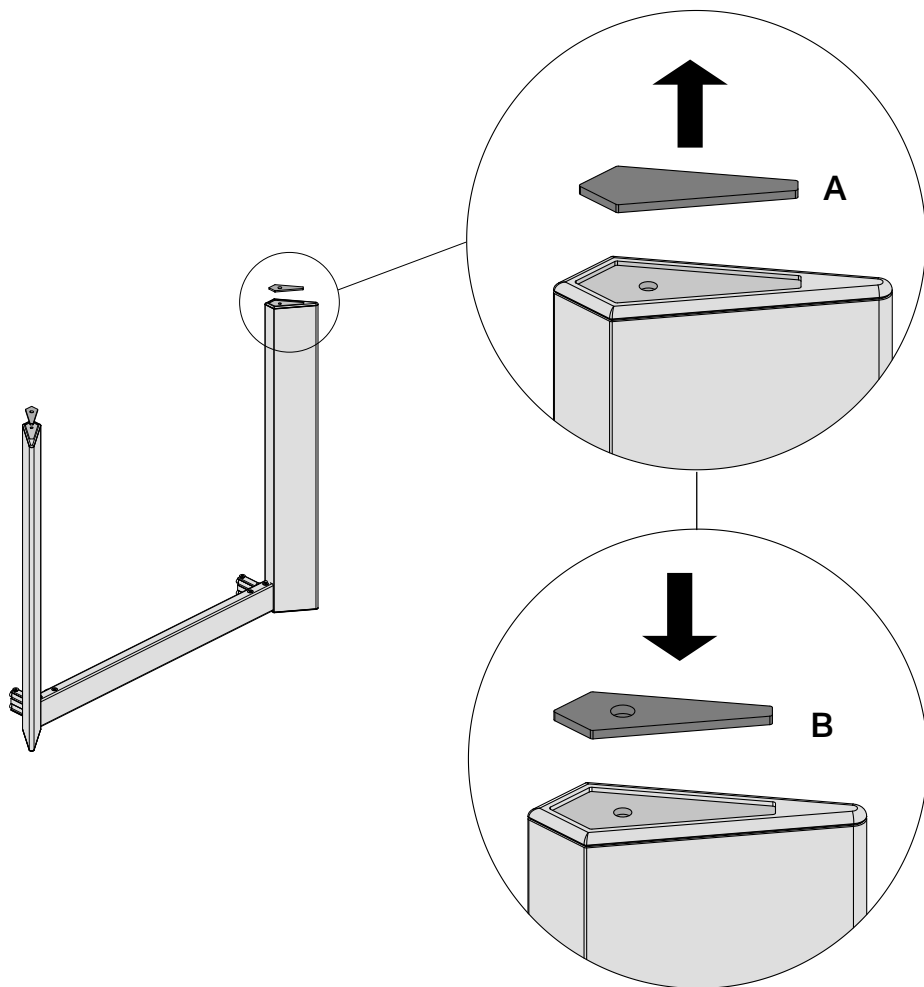

IT In caso di uso esterno del tavolo sostituire i feltrini (A) con i gommini adesivi (B con foro) in dotazione.

EN For outdoor use please replace the felt pads (A) with the supplied rubber pads (B with hole).

DE Im Fall von Benutzung des Tisches im Aussenbereich, tauschen Sie die Filzgleitern (A) mit den Klebe-Fussgleitern (B mit Loch) aus.

FR Au cas où la table serait utilisée à l'extérieur, il faut remplacer les feutres (A) avec les patins adhésifs (B avec trou) fournis.

ES En caso de que la mesa sea utilizada al exterior, hay que reemplazar los fieltros (A) por los tapones de goma adhesivos (B con hoyo) en dotación.

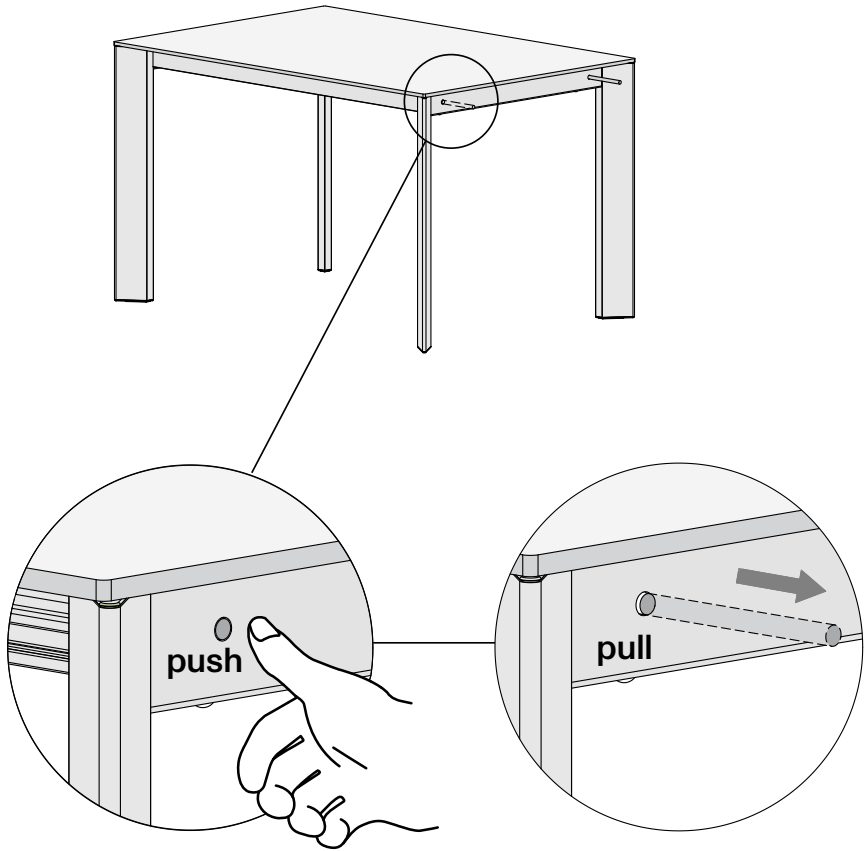

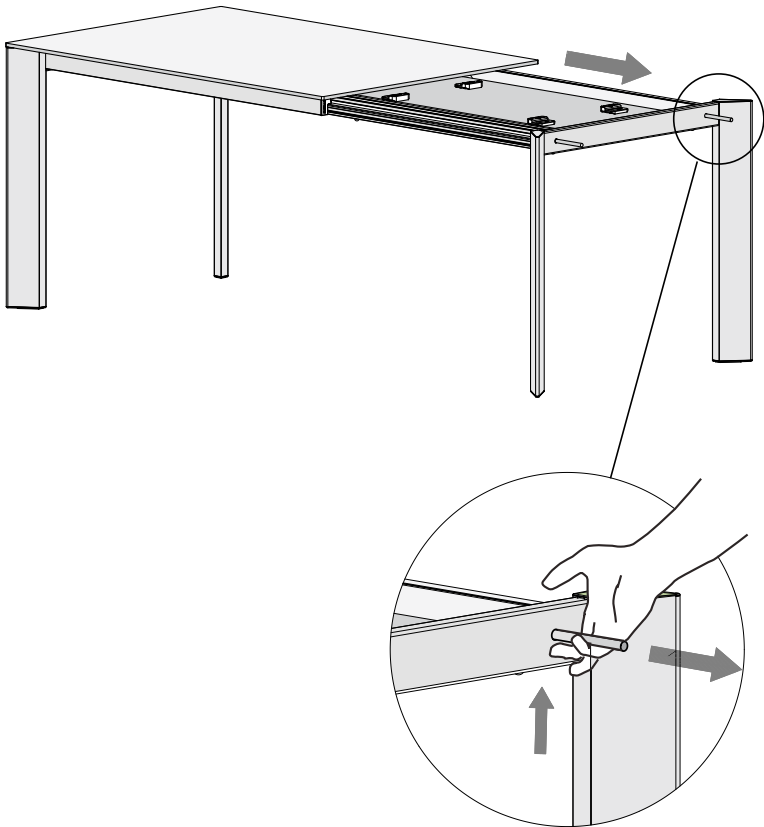

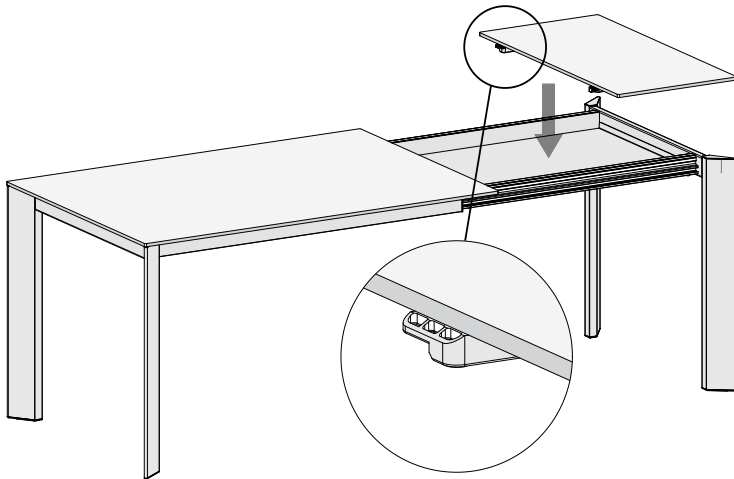
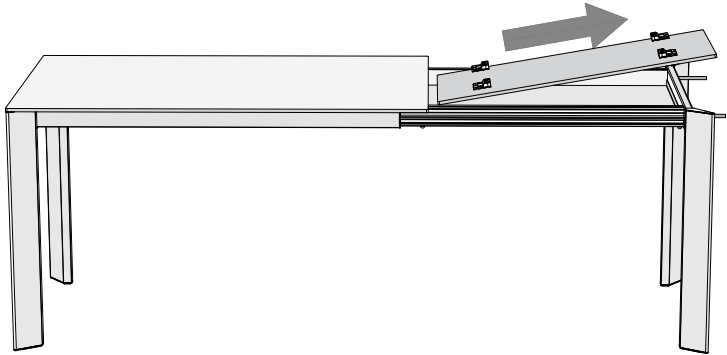

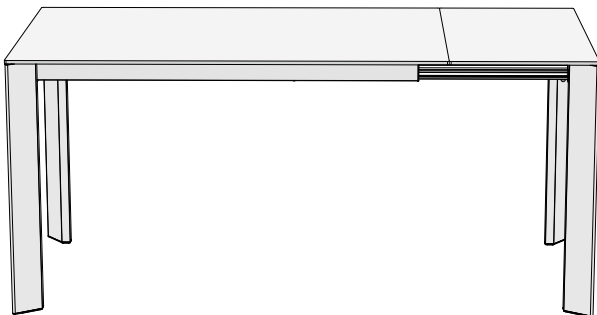
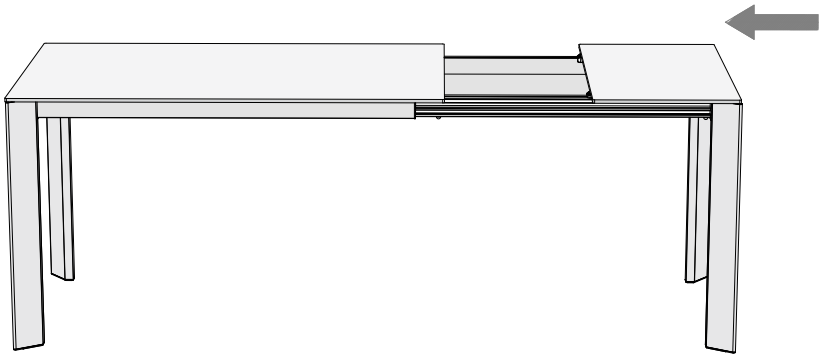

Desalto Spa
Via per Montesolaro
22063 Cantù (CO)
Italy

T. +39 031 7832211
F. +39 031 7832290
info@desalto.it
www.desalto.it

06 / 2023

DESALTO